

## Data Sheet-Aluminum Profile

### EKPF73 - Perfil pendente de alumínio

#### Descrição:

É o detalhe que faz toda diferença no ambiente. Oferecemos perfis com 2 metros para total liberdade nos seus projetos.



#### Indicação:

Difusor alto / Pendente / alto

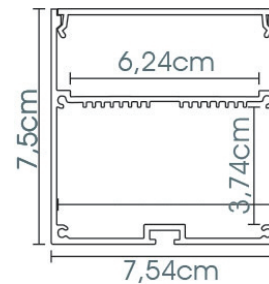

### Perfil de alumínio com acrílico PMMA para pendente

#### Areas of application:

Edge lighting  
Strip lighting  
Cover lighting  
Anywhere LED flex or an LED module needs extra support

## Data Sheet-Aluminum Profile

### Specification

Aluminum profile	EKPF73
Diffuser	PC frosted cover
Length	2000mm/3000mm
Weight	1.930kg/m
Max LED Strip Width	51.5mm
Finish	Silver / Black anodized , Powder coated white / black or other colors
Installation	Surface / Pendant

### Assembly Information

- The aluminum profile can be installed using the mounting brackets or fitted directly using countersunk screws;
- The advantage of using mounting brackets is the LED flex can be fitted into the aluminum profile before locating into the mounting brackets;
- The aluminum profile can be cut to size and butted together;
- Prior to installation clean the inner surface of the aluminum profile thoroughly with a spirit cleaner, this ensures a good bond with the flex;
- When fitting the feed connectors avoid excessive pressure;
- As with all LED flex avoid sharp bends and static.

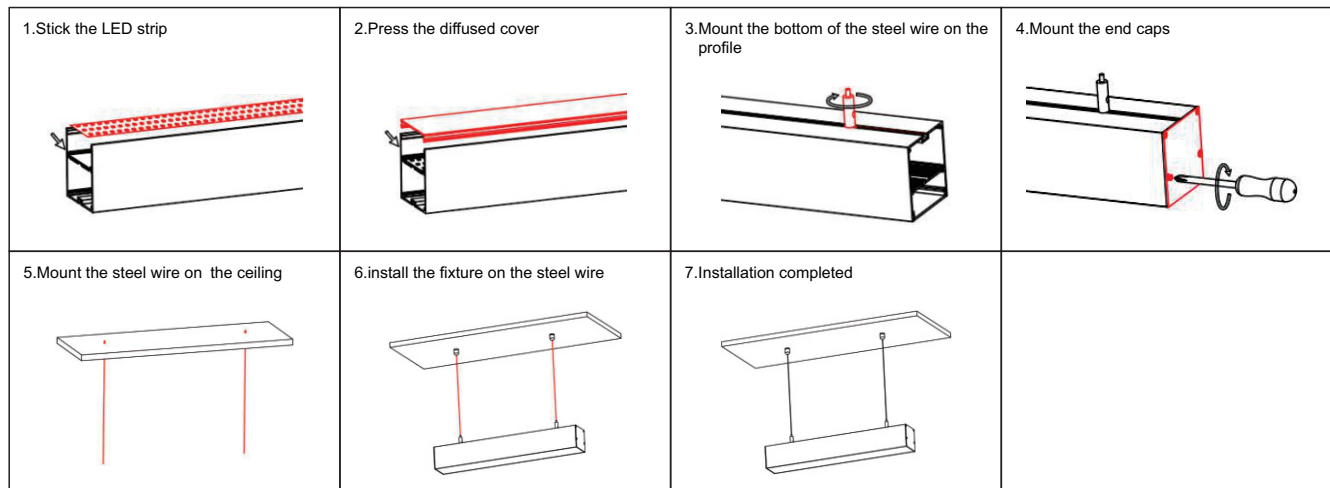

### Installation method



## Data Sheet-Aluminum Profile

New aluminum track from EKLART to be used with light flex or other LED modules. The track works as an excellent heat sink, providing optimum cooling of LED modules for long life and high reliability. Some tracks have covers included in the price. There is a choice of covers (clear, frosted or milky) plus mounting brackets and end caps for easy mounting and installation of LED modules. The tracks can be shortened to the desired length.

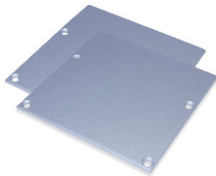
### Packing Included

	
Item no.:EKPF73	Aluminum profile+diffuser
	
Tampa final (par)	Suporte para pendente

If you are not familiar with the application of the product at hand, especially with the handling according to given regulations, it is essential to get in contact with our technical application support department.